

No matter which of our vane grinders you choose you will get durable tools with high power and low weight. In addition, vibrations and noise are on a low level.

- LSV19** – For work in cramped spaces, the LSV19 is small yet powerful, and lubrication free.
 Features: Speed governor, sealed angle head, thermally insulated handle and lubrication-free air motor.
- LSV28** – Small, yet powerful giving 0.75 kW.
 Features: Speed governor, sealed angle head, thermally insulated handle and lubrication-free air motor (LSV28 S060-18 model).
- LSV39** – If you are looking for the most powerful one-hand angle grinder on the market, then you have found it – up to 1.8 kW.
 Features: Speed governor, sealed angle head, lubrication-free air motor, lockable spindle and thermally insulated handle. The auto balancer reduces the vibrations by up to 50%.
- LSV48** – Our most powerful angle vane grinder with 1.9 kW for ultimate productivity.
 Features: Speed governor, sealed angle head, lubrication-free air motor, lockable spindle and thermally insulated handle. The autobalancer reduces the vibrations by up to 50%.



LSV28



LSV39



LSV19



LSV48

| Model | Max free speed r/min | For wheel dia DxTxH ^a mm | Spindle thread and length | Max output | | Weight | | Height over spindle mm | Air consumption at | | | | Rec. hose size | | Air inlet thread BSP | Ordering No. |
|-----------------------|----------------------|-------------------------------------|---------------------------|------------|------|--------|-----|------------------------|--------------------|------|------|------|----------------|-----|----------------------|--------------|
| | | | | kW | hp | kg | lb | | l/s | cfm | l/s | cfm | mm | in | | |
| LSV19 S170-08 | 17000 | 80x7x10 | UNF 3/8"x17 | 0.45 | 0.60 | 0.7 | 1.6 | 71 | 11.2 | 23.0 | 6.6 | 14.0 | 10 | 3/8 | 1/4 | 8423 0111 40 |
| LSV28 ST12-10 | 12000 | 100x7x16 | UNF 3/8"x17 | 0.75 | 1.00 | 1.7 | 3.7 | 75 | 17.4 | 36.9 | 7.5 | 15.9 | 10 | 3/8 | 3/8 | 8423 0125 14 |
| LSV28 ST13-10E | 13000 | 100x7x9.5 | UNF 3/8"x17 | 0.75 | 1.00 | 1.5 | 3.3 | 70 | 21.5 | 45.0 | 14.5 | 30.0 | 10 | 3/8 | 3/8 | 8423 0125 29 |
| LSV28 ST12-12 | 12000 | 115x7x22 | UNF 3/8"x17 | 0.75 | 1.00 | 1.7 | 3.7 | 75 | 17.4 | 36.9 | 7.5 | 15.9 | 10 | 3/8 | 3/8 | 8423 0125 16 |
| LSV28 ST12-13 | 12000 | 125x7x22 | UNF 3/8"x17 | 0.75 | 1.00 | 1.7 | 3.7 | 75 | 17.4 | 36.9 | 7.5 | 15.9 | 10 | 3/8 | 3/8 | 8423 0125 17 |
| LSV28 S060-18 | 6000 | 180 ^b | UNC 5/8"x32 | 0.73 | 0.98 | 2.5 | 5.4 | 87 | 16.0 | 33.9 | 7.3 | 15.5 | 10 | 3/8 | 3/8 | 8423 0135 53 |
| LSV39 SA12-125 | 12000 | 125x7x22 | M14x21 | 1.80 | 2.40 | 1.8 | 4.0 | 96 | 29.8 | 63.0 | 17.6 | 37.0 | 13 | 1/2 | 3/8 | 8423 0133 01 |
| LSV48 SA085-18 | 8500 | 180x7x22 | M14x9 | 1.9 | 2.5 | 2.7 | 5.9 | 88 | 36.0 | 76.0 | 17.0 | 36.0 | 16 | 5/8 | 1/2 | 8423 0132 06 |
| LSV48 SA066-23 | 6600 | 230x7x22 | UNC 5/8"x10 | 1.9 | 2.5 | 2.9 | 6.4 | 88 | 36.0 | 76.0 | 17.0 | 36.0 | 16 | 5/8 | 1/2 | 8423 0132 08 |
| For wire brush | | | | | | | | | | | | | | | | |
| LSV39 SA085-125 | 8500 | 125x7x22 | M14x21 | 1.80 | 2.40 | 1.8 | 4.0 | 96 | 29.5 | 61.1 | 16.3 | 33.7 | 13 | 1/2 | 3/8 | 8423 0133 09 |

^a DxTxH = Diameter x Thickness x Hole.

^b Specially for flexible depressed center wheel.

SA = Autobalancer.

With wheel guard for wheel diam. –08 = Ø 80 mm

–10 = Ø 100 mm

–12 = Ø 115 mm

–125 = Ø 125 mm

–13 = Ø 125 mm

–18 = Ø 180 mm

–23 = Ø 230 mm



Service Kits

| | |
|-------|--------------|
| LSV19 | 4081 0486 90 |
| LSV28 | 4081 0317 90 |
| LSV39 | 4081 0537 90 |
| LSV48 | 4081 0312 90 |

Accessories Included

LSV19

Wheel guard 80 mm
 Flanges 4150 1158 80
 Air hose nipple, clamp
 Wrenches
 Exhaust hose set

LSV28

Wheel guard
 Flanges 4150 1160 80
 Support handle 4150 1521 80
 Air hose, air hose nipple, clamp
 Wrenches
 Exhaust hose set

LSV39

Adjustable wheel guard
 Wheel attachment flanges
 Wrenches for flanges
 Spindle lock
 Soft grip support handle
 Exhaust hose
 Autobalancer
 Whip hose Turbo 13 with ErgoNIP 10

LSV48

Wheel guard
 Flange nut 4150 1160 02
 Support handle 4175 0868 82

Optional Accessories

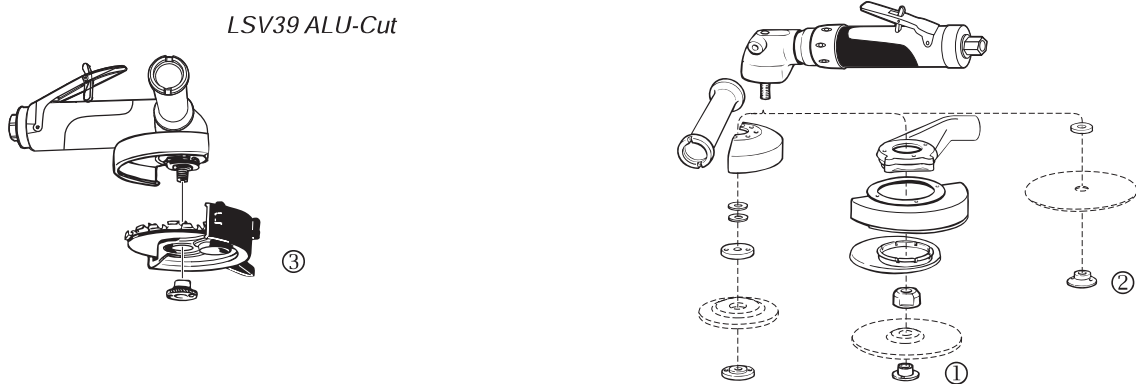

| | LSV28 | LSV39 | LSV48 | See illustration |
|---|--------------|---------------------------|--------------|------------------|
| Spot suction kit for depressed center wheel Ø 125 mm | 3780 4008 70 | 3780 4008 73 | - | 1 |
| Spot suction for diamond cutting blade Ø 125 mm (Cutting depth 30 mm) | - | 3780 4008 74 | - | - |
| Ø 180 mm (Cutting depth 50 mm) | - | - | 3780 4093 42 | - |
| Diamond cutting blade Ø 75 mm | 3780 5073 00 | - | - | - |
| Ø 100 mm | 3780 5074 00 | - | - | - |
| Ø 125 mm | - | 3780 5074 61 | - | - |
| Ø 180 mm | - | - | 3780 5074 62 | - |
| Alu-Cut Alu-Cut guard kit | - | 4112 1166 90 | - | 3 |
| Carbide tipped cutter Ø 125 mm, t=2 mm | - | 4112 1164 00 ^a | - | - |
| Carbide tipped cutter Ø 125 mm, t=4 mm | - | 4112 1162 00 ^b | - | - |
| Adapter for fitting flexible depressed center wheel (for LSV28 S060-18) | 4170 0759 00 | - | - | 2 |
| Quick flange nut, M14 Fixtec nut | - | 4150 1929 00 | 4150 1929 00 | - |
| Add on spot suction Ø 115-125 mm | 3780 4032 14 | 3780 4032 14 | 3780 4032 14 | - |
| Ø 180-230 mm | - | - | 3780 4032 12 | - |

^a For cutting applications in aluminum.

^b For milling applications in aluminum.

Productivity Kits

| Model | Air inlet BSP | Max air flow | Hose, 5 m | Coupling | Lubrication | Ordering No. |
|--|------------------|-----------------|--------------|------------|-------------|--------------|
| MIDI Optimizer F/RD EQ10-R13-W, incl. whiphose | 3/8 | 23 l/s | Rubair 13 mm | ErgoQIC 10 | Yes | 8202 0850 14 |
| MIDI Optimizer F/RD EQ10-R13-W, incl. whiphose | - | 23 l/s | Rubair 13 mm | ErgoQIC 10 | Yes | 8202 0850 15 |
| MIDI Optimizer F/RD EQ10-T13 | 3/8 | 35 l/s | Turbo 13 mm | ErgoQIC 10 | Yes | 8202 0850 17 |
| MIDI Optimizer F/R EQ10-T13 | 1/2 | 35 l/s | Turbo 13 mm | ErgoQIC 10 | No | 8202 0850 04 |
| MIDI Optimizer F/RD EQ10-T13 | 1/2 | 35 l/s | Turbo 13 mm | ErgoQIC 10 | Yes | 8202 0850 13 |
| MIDI Optimizer F/RD EQ10-T16 | 1/2 | 40 l/s | Turbo 16 mm | ErgoQIC 10 | Yes | 8202 0850 12 |