

Controller - CVIR II-H4



Optional Kit IP54 CVIx2

MAIN FUNCTIONS	CVIR II H4
Programming modes	
Number of cycles	50
Number of phases	15
Reverse	✓
1 sequence	8 cycles
Batch count	999
Barcode reading (cycle selection)	✓
LCD screen and display	✓
CVIPC software	✓
Phases characteristics	
Search sequence	✓
Run down speed phase	✓
Final speed phase	✓
Jump to another phase	✓
Cycle characteristics	
Autorized directions	✓
Disengagement parameters	✓
Tigtning results	
Led "Low", "OK", "High" Torque	✓
Led "Low", "OK", "High" Angle	✓
Torque+Angle+Date+Time+Report	2000 to 10000 according to configuration
Number of curves	10
Tightening strategies	
Torque control	✓
Torque control + Angle monitoring	✓
Angle control + Torque monitoring	✓
Maintenance	
Access to all tool memory parameters	✓
Autotest of the complete system	✓
Calibration of the tool (supervisor mode)	✓

MODEL	PART NUMBER	TOOLS	CONSUMPTION (CURRENT)		MAINS SUPPLY	DIMENSIONS			WEIGHT				
			115 V	230 V		WIDTH	HEIGHT	DEPTH	kg	lb.			
CVIR II H4	615 932 685 0	ERP-HT	4A	2A	Single-phase	mm	in.	mm	in.	mm	in.	kg	lb.
						130	5.1	278	10.9	291	11.5	5.9	13

Software, Upgrade kits...

POWER CORD to be ordered with the controller

PLUG	DESCRIPTION	PART NO.
A	European	615 917 201 0
B	US	615 917 203 0
C	UK	615 917 202 0
D	Chinese	615 917 206 0

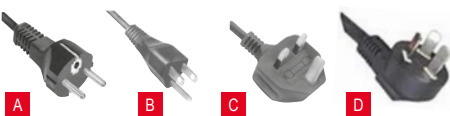

Software

MODEL	PART NO.
CVI PC2000-STD 1 install	615 927 522 0
CVI PC2000 advance 1 install	615 927 523 0
CVINET WEB 1 controller	615 927 736 0
Open protocol 1 license	615 927 830 0



OPTIONAL ACCESSORIES

	PART NO.
• Kit IP54 CVIx2	615 932 684 5
• Shelf support - Aluminium profile	615 397 403 5
• BRDx2 (Backup Rescue Device)	615 936 328 0

Fieldbus / Protocol

MODEL	PART NO.
Ethernet IP Module	615 927 594 0
Profibus DP Module	615 927 595 0
ProfiNet Module (1 port)	615 927 596 0
ProfiNet Module (2 ports)	615 927 597 0
CC-Link Module	615 927 598 0
Devicenet Module	615 927 599 0
MODBUS TCP Slave	615 927 615 0

Electric transducerized High torque - CVIR II

75 to 1700 Nm (55 to 1253 ft.lb) - 85 to 822 rpm

The transducerized nutrunners range ERP is dedicated to high torque applications, especially structural assemblies requiring accuracy and traceability



A



B



C



desoutter.info/ERP

PIC REF	MODEL	PART NUMBER	OUTPUT DRIVE	TORQUE RANGE				MAX RUNDOWN TORQUE	SPEED	GEARBOX DIAMETER		LENGHT		WEIGHT		SPLINE
				MIN.	MAX.	MIN.	MAX.			mm	in.	mm	in.	kg	lb	
A	ERP250	615 165 883 0	3/4	75	250	55	184	18	822	54	2.13	355	13.9	5.1	11.2	3
B	ERP500	615 165 884 0	3/4	150	500	110	368	37	347	67	2.64	390	15.3	5.8	12.8	4
C	ERP750	615 165 885 0	1	225	750	165	553	56	245	67	2.64	410	16.1	6.2	13.7	5
C	ERP1000	615 165 886 0	1	300	1000	221	737	75	205	67	2.64	420	16.5	6.4	14.1	5
•	ERP1700	615 165 887 0	1	510	1700	376	1253	127	85	84	3.31	455	17.9	8.3	18.3	9

OPTIONAL ACCESSORIES

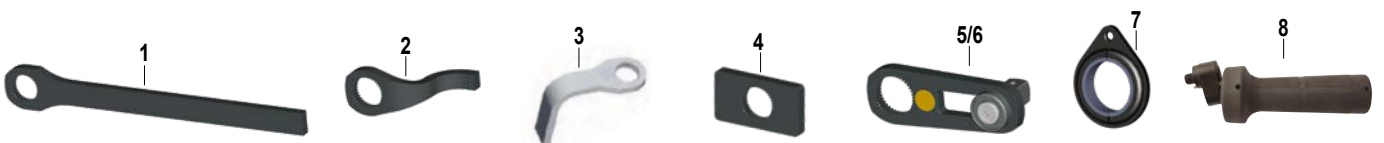

REACTION BARS	SPLINE	1	2	3	4	5	6	7	8
		STRAIGHT	S-TYPE	L TYPE ALUMINIUM	SQUARE	SLIDING DRIVE	SLIDING DRIVE EXTENDED C-C	SUSPENSION BAIL	SIDE HANDLE
ERP250	3	615 812 097 5	615 812 068 5	615 812 072 5	615 812 057 5	615 812 113 5	N/A	615 812 123 0	615 576 085 0
ERP500	4	615 812 054 5	615 812 069 5	615 812 073 5	615 812 058 5	615 812 062 5	615 812 063 5	615 812 123 0	615 576 085 0
ERP750 / ERP1000	5	615 812 055 5	615 812 070 5	N/A	615 812 059 5	615 812 064 5	615 812 065 5	615 812 123 0	615 576 085 0
ERP1700	9	615 812 056 5	615 812 071 5	N/A	615 812 060 5	615 812 066 5	615 812 067 5	615 812 123 0	615 576 085 0



NUTRUNNER CABLE	PART NO.
Tool cable 3m (9.8ft)	615 917 461 0
Tool cable 5m (16ft)	615 917 462 0
Tool cable 10m (32.8ft)	615 917 464 0
Tool cable 15m (49.2ft)	615 917 465 0



EXTENSION CABLE	PART NO.
Ext. cable 5m (16ft)	615 917 222 0
Ext. cable 10m (32.8ft)	615 917 224 0

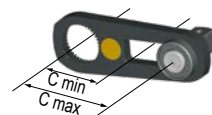

Sliding drive C-C

PART NO.	C MIN	C MAX
	mm (in.)	mm (in.)
615 812 113 5	70 (2.76)	120 (4.72)
615 812 062 5	76 (3)	126 (4.96)
615 812 063 5	82 (3.23)	218 (8.58)
615 812 064 5	80 (3.15)	125 (4.92)
615 812 065 5	82 (3.23)	218 (8.58)
615 812 066 5	80 (3.15)	130 (5.11)
615 812 067 5	80 (3.15)	280 (11.0)